**NX35-XL**

Needle roller/axial ball bearing

Schaeffler ID:
0507786250000Needle roller/axial ball bearings NX,
single direction axial component, for oil
lubrication

X-life

Technical information

2)

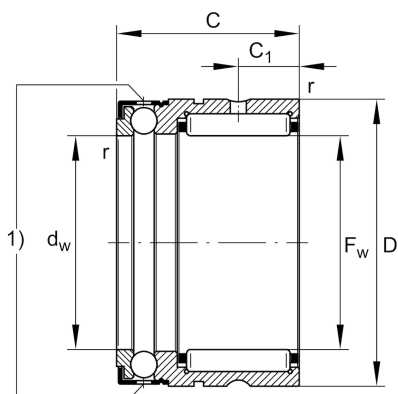
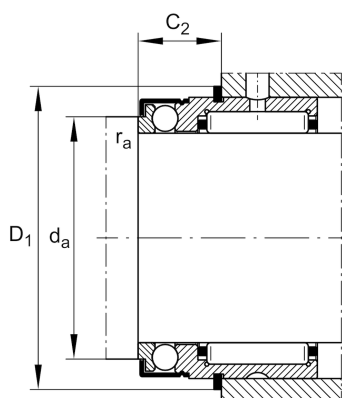
**Main Dimensions & Performance Data**

F_w	35 mm	Bore diameter
D	47 mm	Outside diameter
C	30 mm	Height
C_r	27,500 N	Basic dynamic load rating, radial
C_{0r}	41,500 N	Basic static load rating, radial
C_a	12,400 N	Basic dynamic load rating, axial
C_{0a}	32,500 N	Basic static load rating, axial
C_{ur}	7,400 N	Fatigue load limit, radial
C_{ua}	1,480 N	Fatigue load limit, axial
n_G	3,700 1/min	Limiting speed
	136.52 g	Weight

Dimensions

	IR30X35X20-XL	Suitable inner rings IR
	WR47, SW47	Snap ring
C_1	10 mm	Distance to lubrication hole
C_2	10 mm	Distance to lubrication hole
d_w	35 mm	Bore diameter of shaft washer
r_{min}	0.3 mm	Minimum chamfer dimension

Mounting dimensions

d_a	40.5 mm	Mounting dimension shaft shoulder
$r_{a max}$	0.3 mm	Maximum recess radius
D_1	50.1 mm	Connection diameter snap ring
C_2	14.2 mm	Connection width with snap ring

Temperature range

T_{min}	-30 °C	Operating temperature min.
T_{max}	120 °C	Operating temperature max.